

# CARLETON™ CANOPY 1400 INSTALLATION INSTRUCTIONS

**IMPORTANT NOTE: ENSURE ALL RELEVANT PERSONNEL READ THE POINTS LISTED WITHIN THIS LEAFLET AND THAT A COPY IS GIVEN TO STAFF INVOLVED WITH THE INSTALLATION AND MAINTENANCE OF THIS PRODUCT.**

## KIT CONTENTS

1 x 1.4m Canopy  
4 x Wall fixings  
4 x Cover caps

## TOOLS REQUIRED

Tape measure	17mm Socket bit
Hammer battery drill	Pencil/Scriber
12mm Masonry drill bit	Hammer
Socket set	17mm Spanner

## NOTE:

The canopy is supplied with wall fixings suitable for solid walls of adequate strength. Although most solid and cavity walls can typically support the canopies, they should be assessed for adequate strength and stability by a suitably qualified person. There are a number of other anchors and resin fixings that are probably suitable for your particular site conditions, and the appropriate fixing type should be chosen.

## INSTALLATION INSTRUCTIONS

**NOTE: A minimum of 2 suitably experienced persons are required for this installation.**

**Weight of the canopy: 24kg**

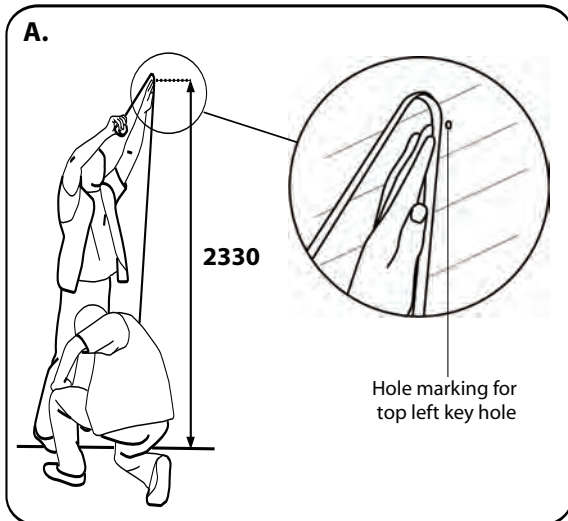

**1.** Firstly establish the location your Carleton canopy is to be sited. To install your canopy we recommend installing from the upper left fixing key hole. From the ground measure approximately 2330mm upwards on the wall and mark the centre using a pencil/scriber (diagram A).

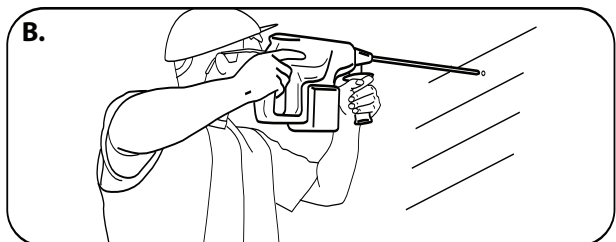

**2.** Using a 12mm masonry drill bit and a hammer drill, drill the marked hole to a depth of 110mm (diagram B).

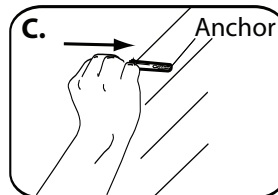

**3.** Hammer the anchor into the drilled hole making sure it is fully inserted (diagram C). Tighten the anchor using a 17mm socket until it is firmly secure. Once secure, then unscrew the bolt until it is around 30mm proud of the wall (diagram D) for the canopy to be hooked onto.

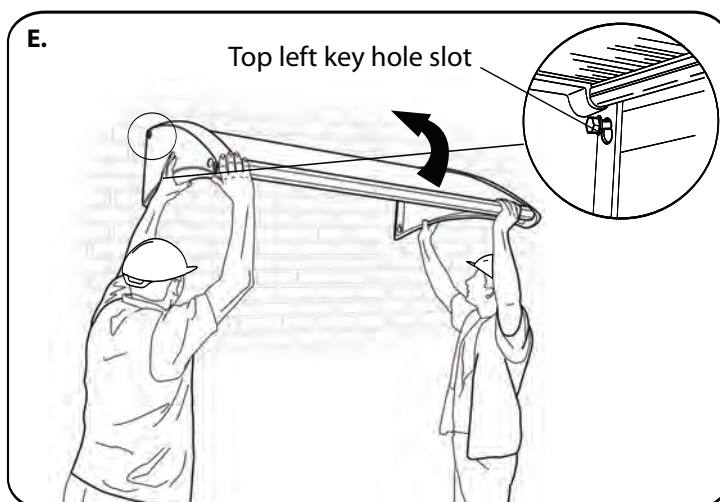
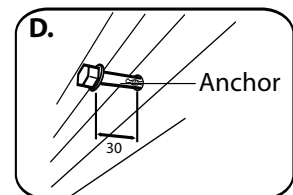

**4.** Lift the canopy up and position the top left key hole slot on the protruding screw. Pivot the canopy up at the opposite side ensuring the canopy is level either with the mortar joints or by using a spirit level (diagram E).

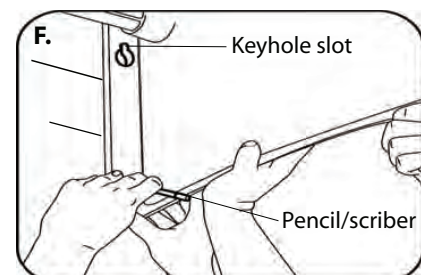

**5.** Mark the remaining 3 holes of your canopy using a pencil/scriber (diagram F) then carefully remove the canopy from the screw and place it down on the floor.

## SAFETY NOTE:

Please refer to 'Manual Handling Operations Regulations 1992' during handling of the product.

**6.** Repeat steps 2 & 3 with the remaining marked holes. This will leave four screws protruding from the wall by around 30mm, for the Canopy to be hooked onto.

**7.** Using correct lifting procedures lift the canopy up onto the four protruding screw heads and slot down into the key hole slots making sure the washers are on the front face of the canopy. Care should be taken not to scratch the back surface of the canopy against the wall as this may damage the protective coating (diagram G, G.1, G.2).

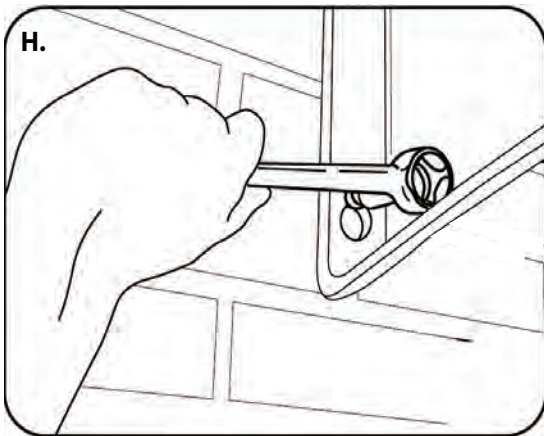
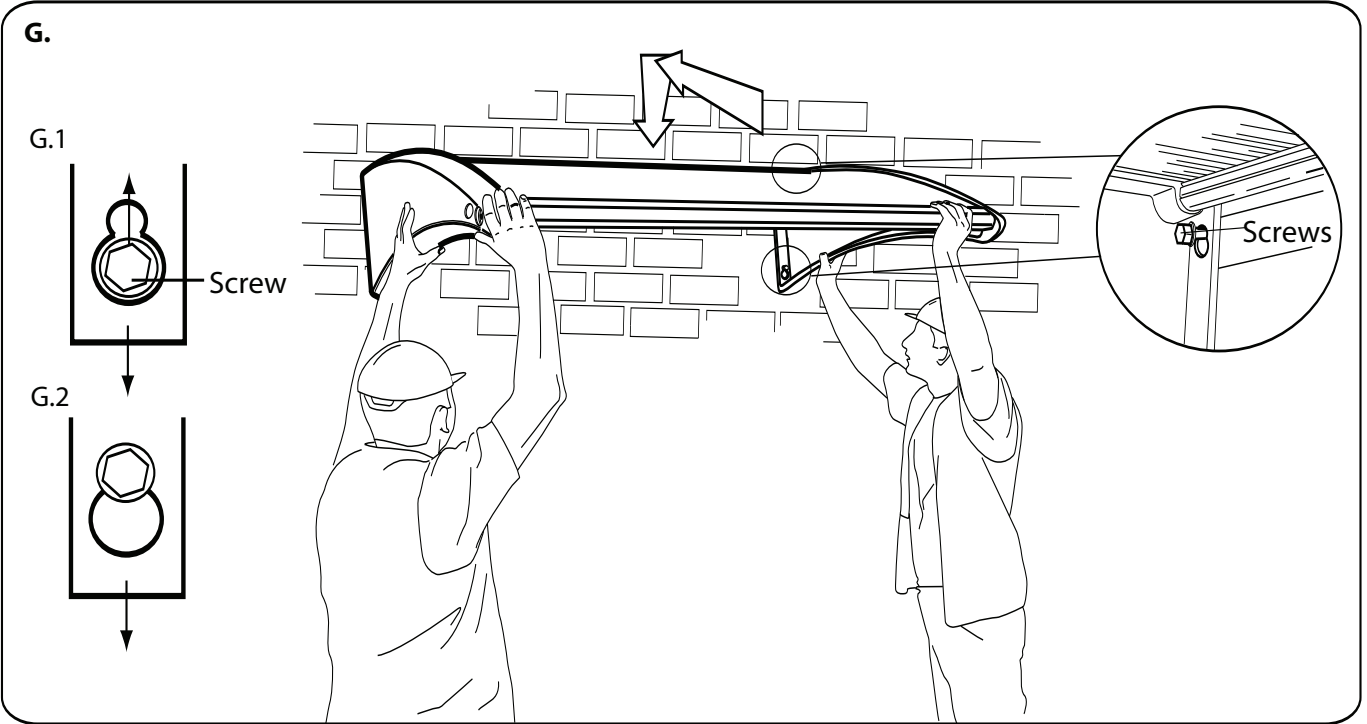

**8.** Using a 17mm socket or spanner tighten the four fixings screws to the correct torque until the canopy is securely fixed to the wall (diagram H).

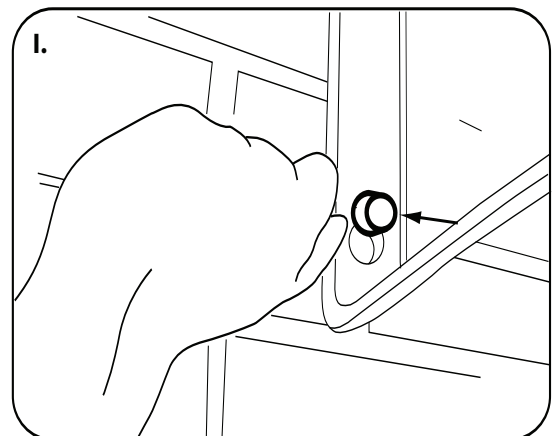

**9.** To complete your installation push the tamper-resistant cover caps onto the screw heads - a hammer maybe required (diagram I).

# CARLETON CANOPY 2800, 4200 INSTALLATION INSTRUCTIONS

**NOTE: A minimum of 3-4 suitably experienced persons are required for this installation.**

**Weight of the canopies: Carleton 2800 - 41kg, Carleton 4200 - 58kg.**

## KIT CONTENTS

### Carleton 2800

1 x 2.8m Canopy  
6 x Wall fixings  
6 x Cover caps

### Carleton 4200

1 x 4.2m Canopy  
8 x Wall fixings  
8 x Cover caps

## TOOLS REQUIRED

Tape measure  
Hammer battery drill  
12mm Masonry drill bit  
Socket set

17mm Socket bit  
Hammer  
Pencil/Scriber  
17mm Spanner

## INSTALLATION INSTRUCTIONS

Follow steps 1, 2, & 3 from the Carleton 1400 Installation Instructions

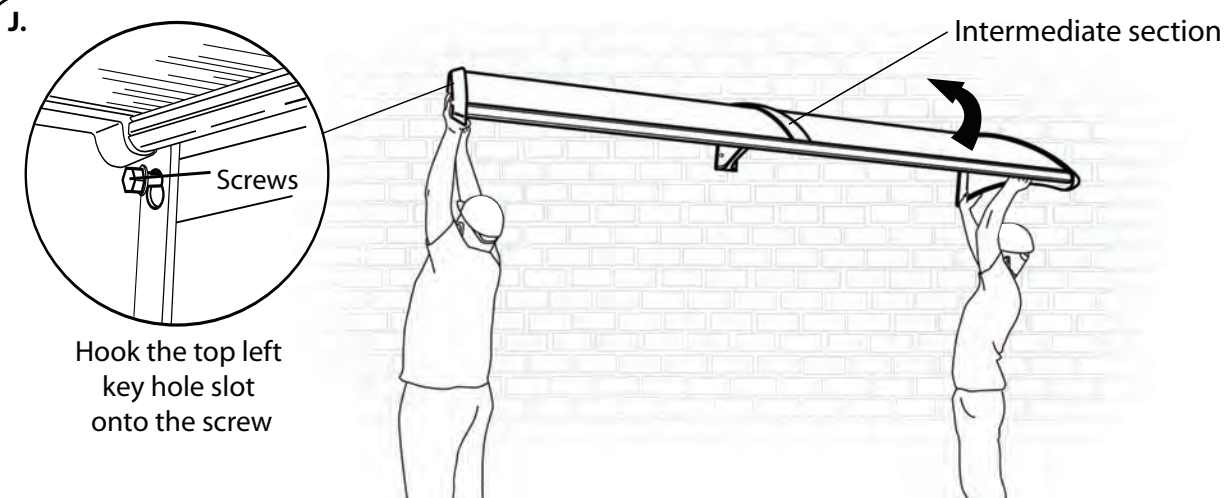

**5.** Lift the canopy up and position the top left key hole slot on the protruding screw head. Pivot the canopy up at the opposite side ensuring the canopy is level either with the mortar joints or by using a spirit level (diagram J).

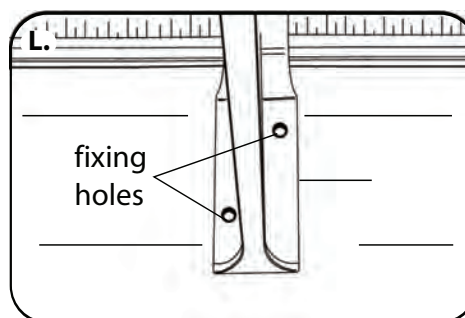
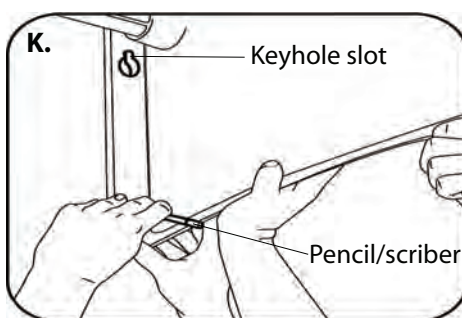

**6.** Once your canopy is level mark the remaining key hole slots (diagram K) and the 2 fixing holes in the intermediate section (diagram L) using a pencil or a scriber.

**7.** Drill the marked holes using a 12mm masonry drill bit and a hammer drill.

**8.** Push or hammer the anchors into the four outer keyhole slots (diagram M, N) making sure they are fully inserted. Tighten all the anchors using a 17mm socket until they are firmly secure. Then unscrew the screw until they are around 30mm proud of the wall for the canopy to be hooked onto (diagram O),.

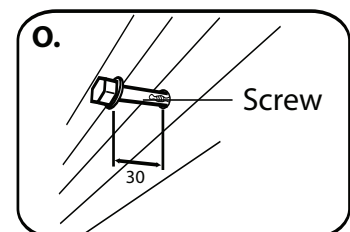
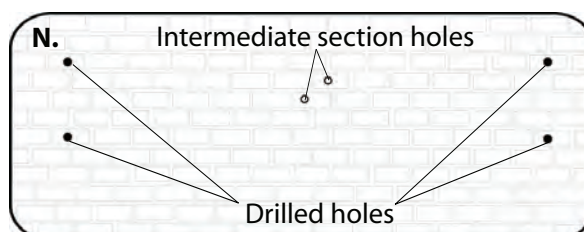
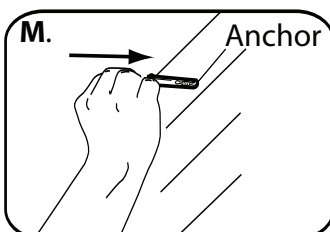



Please refer to 'Manual Handling Operations Regulations 1992' during handling of the product.

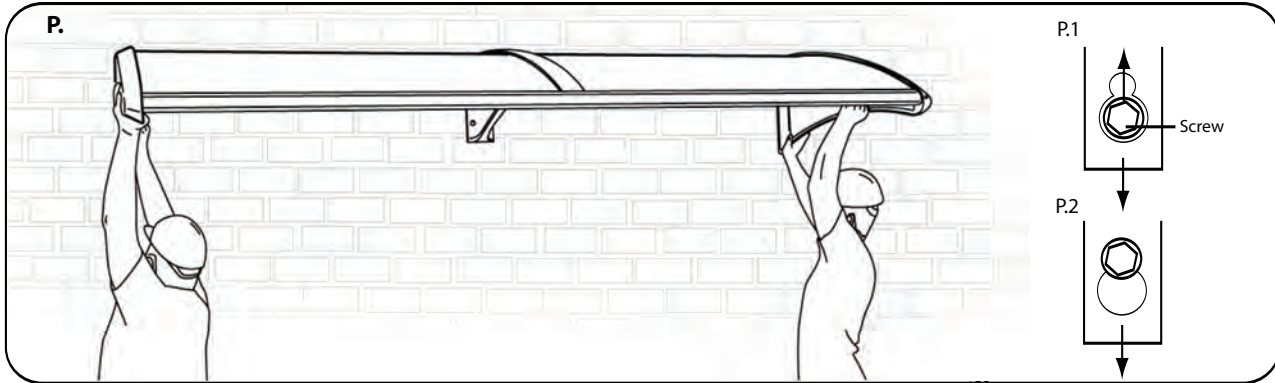

9. Using correct lifting procedures lift the canopy up onto the four protruding screw heads and slot down onto the key hole slots making sure the washers are on the front face of the canopy (diagram P,P.1,P.2). Care should be taken not to scratch the back surface of the canopy against the wall as this may damage the protective coating.

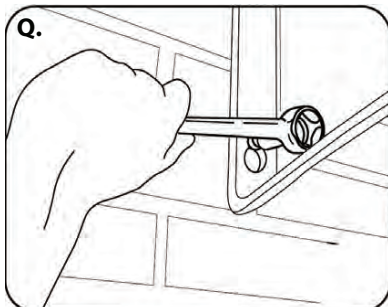

10. Once the canopy is hooked onto the screws tighten them using a 17mm socket until secure (diagram Q).

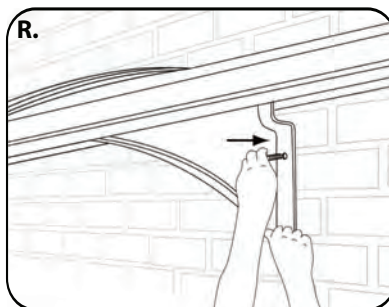

11. Insert the anchors through the holes in the intermediate section and tighten using a 17mm socket (diagram R).

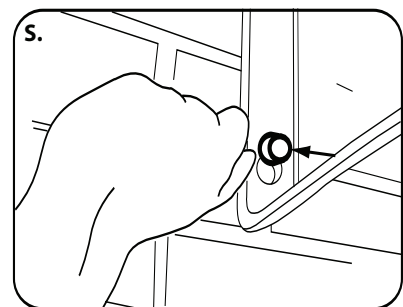

12. To complete your installation push the tamper-resistant cover caps onto the screw heads, a hammer maybe required.(diagram S).

## CARLETON CANOPY 4200 INSTALLATION TIPS

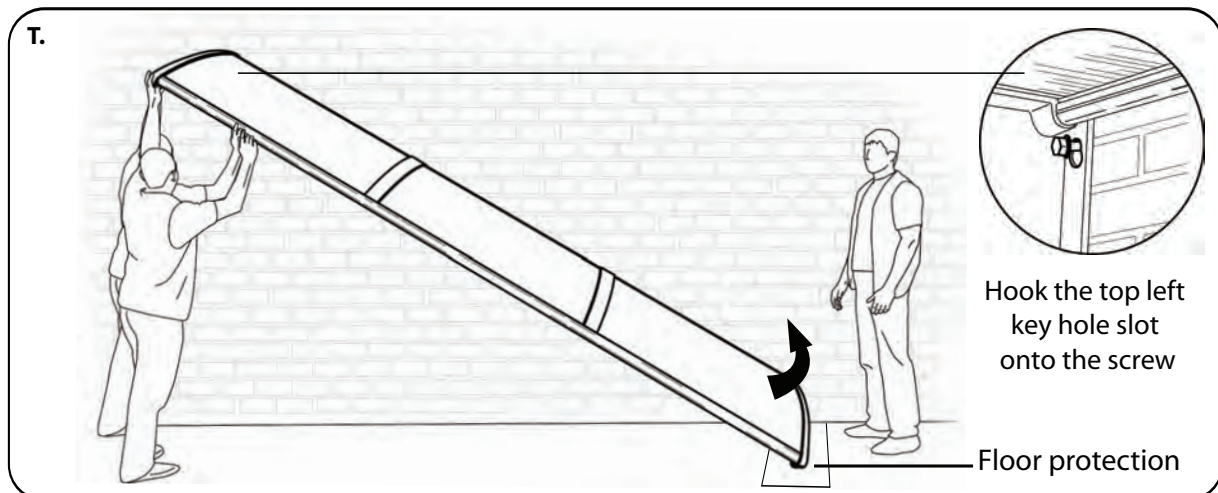

When installing the Carleton canopy 4200 model it is recommended to first lift the left hand side of the canopy onto the protruding screw heads leaving the right hand side on the floor. Once hooked on, pivot the right hand side upwards until it is level. Mark the holes, pivot the right hand side down back onto the floor protection and remove from the wall to drill the holes. Follow step 8 and diagrams M,N & O on the previous page. Reposition the canopy onto the wall using the same pivoting method and tighten the bolts until the canopy is securely fixed.



AND CARLETON™ CANOPY ARE TRADEMARKS OF GLASDON GROUP AND ITS SUBSIDIARIES IN THE UK AND OTHER COUNTRIES

- GLASDON cannot be held responsible for claims arising from incorrect installation, unauthorised modifications or misuse of the product of the product
- Issue 1 - Stock Code 136513 © Copyright 2007
- Glasdon reserve the right to alter specification without prior notice



**Glasdon®**

**Glasdon U.K. Limited**

Preston New Road  
BLACKPOOL  
Lancashire  
FY4 4UL

Tel: (01253) 600410

Fax: (01253) 792558

e-mail: sales@glasdon-uk.co.uk

www.glasdon.com

C000/0154